

FACEBOW RECORDS USING THE DENAR® SLIDEMATIC SYSTEM

OVERVIEW

- The facebow transfer establishes the relationship of the maxillary dentition to the hinge axis of rotation of the mandible, enabling the maxillary model to be mounted on the articulator in the correct anatomical position.
- The increasing importance of aesthetic dentistry in the UK has significantly increased the importance of facebow records and articulators in restorative clinical practice.
- Facebow records provide vital clinical information for the dental laboratory, and are essential for MediMatch to ensure that we consistently provide dental surgeons with restorations of the highest quality.
- MediMatch recommends the Denar® Slidematic facebow. Our laboratory is equipped with the latest Denar® articulators, as we believe that they are the proven articulator of choice.
- The Denar® system allows MediMatch to mount the maxillary cast using only the bitefork assembly supplied by the dental surgeon, so that the relationship with the condylar position is accurately reproduced every time.

Denar® Slidematic Facebow Recording Technique

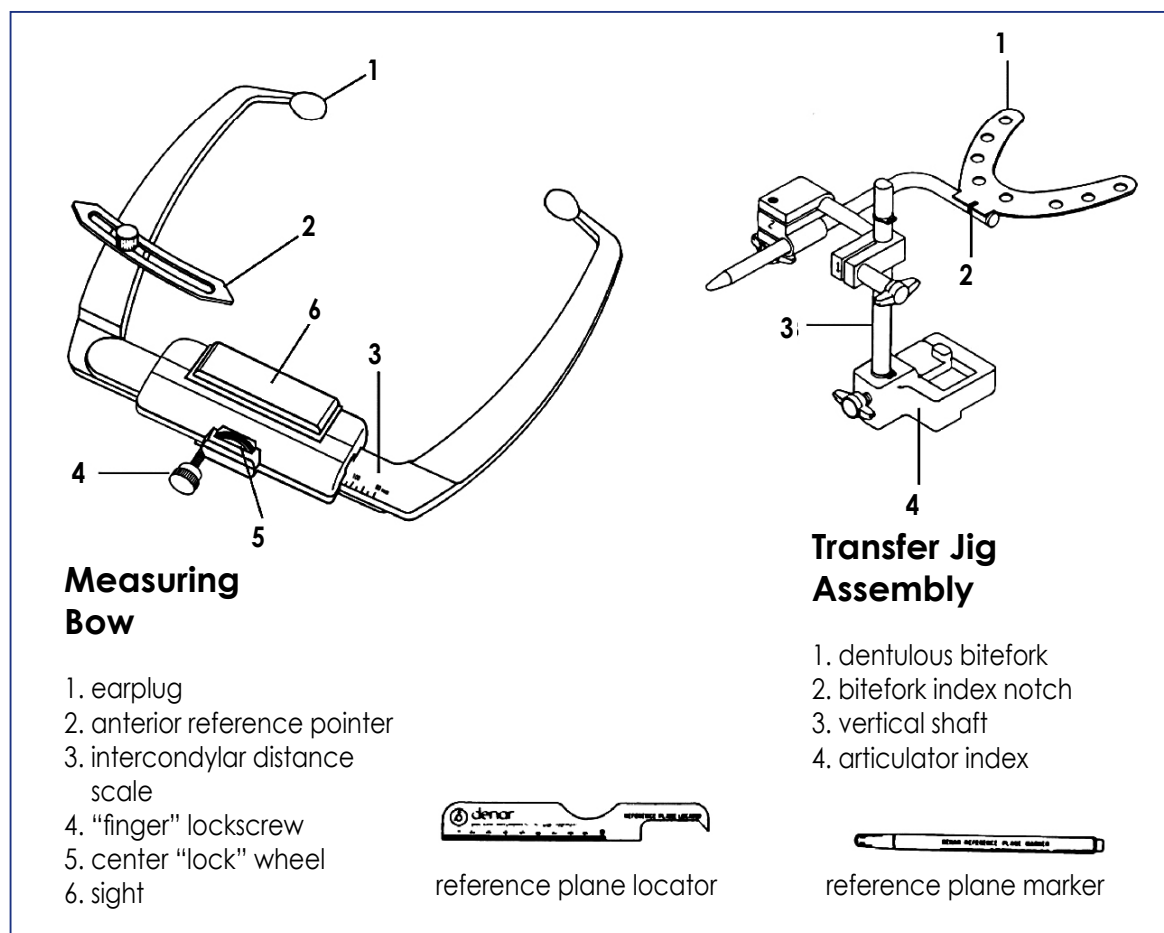

PLEASE REFER TO THE LINE DRAWING OF THE SLIDEMATIC FACEBOW ASSEMBLY ABOVE TO WHEN REVIEWING THE TECHNIQUE DESCRIPTION

TIP 1

The Denar® system is designed so that multiple transfer jigs can be used with only one measuring bow, so there is no surgery downtime for taking facebow transfer records for other patients.

1st STEP

Mark the anterior reference point on the right side of the patient's face using the Reference Plane Locator and Marker provided.



TIP 2

For edentulous patients measure upwards from the lower border of the upper lip at rest, and attach the bitefork to the upper wax rim.

2nd STEP

Cover the bite fork with Blu-Mousse® or *Baseplate Wax softened in warm water, approx. 55 °C (Please refer to the MediMatch "Featured Products" section below).



3rd STEP

With the bitefork arm to the patient's right, place the fork into the mouth, aligning the patient's midline with the bitefork's index notch to orientate the bitefork correctly, and ensuring that it is parallel with the patient's coronal and horizontal planes;

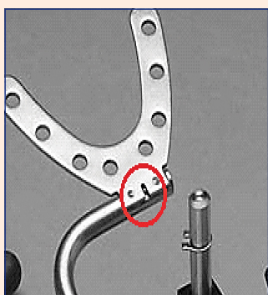

A reinforced cotton roll can be placed under the bitefork to stabilize the bite.



4th STEP

Attach the vertical shaft to the measuring bow with clamp marked #2 on the patient's right and tighten the finger screw (to secure the vertical shaft to the measuring bow and to avoid any movement).



5th STEP

Loosen the center wheel on the top of the measuring bow and slide the bow open to accommodate the width of the patient's face;

Assemble the facebow on the patient by sliding the bitefork arm through clamp #2 (the facebow earpieces should fit into the patients external auditory meatus).

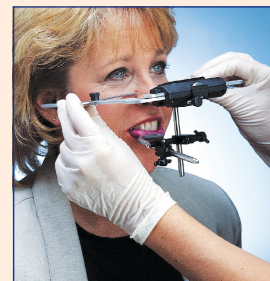

6th STEP

Tighten the center wheel on the measuring bow and loosen the finger screw on the anterior reference pointer. Raise or lower the bow, so that the pointer or sight aligns precisely with the anterior reference point taken at step 1, and tighten clamp #1, then clamp #2.

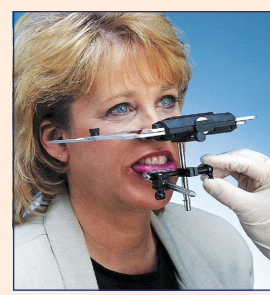

TIP 3

When tightening clamps #1 and #2, care must be taken not to displace the bow to either side by allowing the vertical shaft to rest on the fingers as shown in the figure right:



WEBSHOP
INSTALL



TRAIN
SUPPORT



LAB
DESIGN

7th STEP

Record the patient's intercondylar distance (the measurement indicated on the facebow scale).



11th STEP

Place the bitefork and transfer jig in an autoclave or disinfection bath containing an appropriate disinfectant for the time specified in the manufacturer's instructions;

Remove the bitefork and transfer jig from the decontamination bath, rinse under running water, and then seal in a Grip Seal bag;

Label the grip-seal bag with details of the patient and method of decontamination;

Complete the MediMatch Laboratory Request Form fully, and arrange for despatch to MediMatch as soon as possible;

TIP 4

Bite registrations must ALWAYS be well packed for transfer to the dental laboratory to avoid breakage - bite registration materials are brittle when set.

The Denar® facebow and additional bitefork assembly are now ready for the next patient.

TIP 5

Finger screws and spacers MUST be disinfected in cold disinfectant solution - they MUST NOT be autoclaved. Biteforks MUST be disinfected before each use.

8th STEP

Ask the patient to stand upright, and check that the facebow is parallel to the horizon.



9th STEP

Loosen the finger screw on the facebow, slide it open, and then remove from the patient.



10th STEP

Detach the facebow from the transfer jig by loosening the finger screw (ensure that clamps #1 and #2 are secure)



Images featured in this clinical protocol are reproduced by kind permission of Whipmix® Corporation, Louisville, Kentucky USA and Shannon Pace DA II

Images featured in this clinical protocol are reproduced by kind permission of Whipmix® Corporation, Louisville, Kentucky USA and Shannon Pace DA II



www.medimatch.com